

Incomparable

...to anything else on the market. **The EPIC Block**

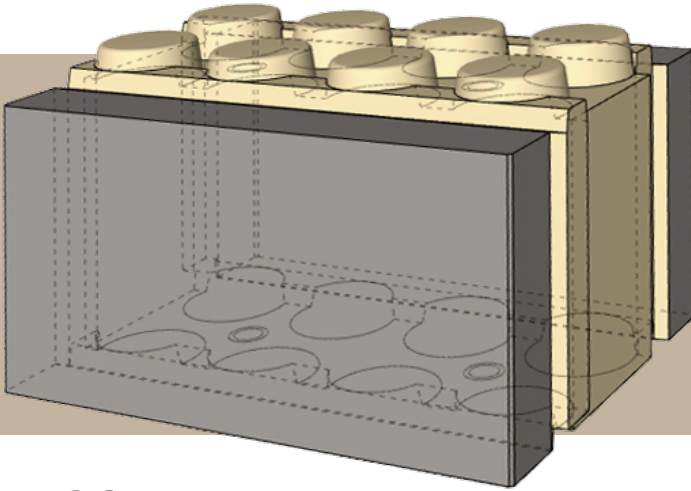

EPIC Features:

- Self Insulated
- Structurally Sound
- Fire Retardant/Proof
- Weather Resistant
- Easy To Install

EPIC Savings:

- Reduced Labor Costs
- Less Material Waste
- Shorter Completion Time
- Thermal Efficiency
- Customer Satisfaction

EPIC Strength:

Even a basic EPIC Block can support 72,000 PLF. With a bonding strength exceeding 60psf, the durable closed cell foam core can hold each side skin at more than 8,000 psf. Strength of wall scalable to design requirement.

Manufacture EPIC Blocks at your existing facility using existing products and greatly increase your profit potential. Great foam products companies like BASF can provide the training and the equipment you need to get started.

EPIC Smarts:

Installed Tech Sockets could house: alarms, cameras, access points, motion detectors and more. Embedded mesh-networked devices can adjust HVAC temperature, ensure vertical alignment, detect cracks, moisture and more.

Invest in EPIC Block. We are currently seeking partners with resources and assistance that can help us change the way the world builds. Charlie Thornton, founder of Thornton Tomasetti and now TGE Topdown is a supporter of this product.

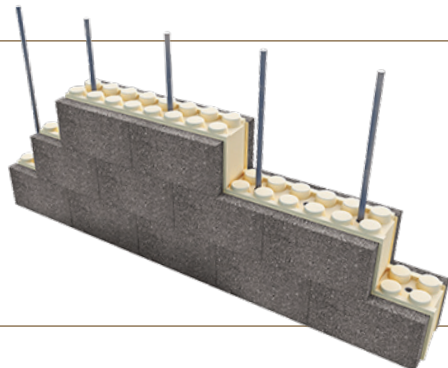

Interested in joint venturing with us? Schedule a meeting to further discuss the next steps in the process of becoming an investor or manufacturer and supplier of the EPIC Block.

Contact Charles Leahy, President & CEO, Eco-Panels / EPIC Block
charles@eco-panels.com | 828-713-2357 | TheEpicBlock.com

From The Makers Of:

eco panels

Stronger & More
Energy Efficient
Building Panels



EPIC BLOCK

Insulated • Interlocking • Intuitive

Partnered
With **BASF**
Corporation

Soon To Be:

In Your Investment Portfolio
In Your Manufacturing Plant
In Buildings Around the World